

# The Future

---

SITE PLANNING TEAM

HUTTO DISCOVERY UNITED METHODIST CHURCH



# Why do we have a Site Planning Team?

---

To provide a road map of improvements to accommodate and encourage Hutto Discovery UMC's growth plans and make the best use of its 10 acre site.

# How did we get here?

---

Based on feedback from you and meetings with Healthy Church Initiative, the Site Planning Team sought to provide a nursery closer to services, additional classrooms and meeting spaces, a children's playground, an expanded worship center, and a family life center to foster flexibility, growth and a sense of community.

Addressed the needs of our community, including a population growth of unchurched families with young children and youth.

Addressed the current state of our campus and determined ways to improve areas where it is lacking.

# Phase I - 2016

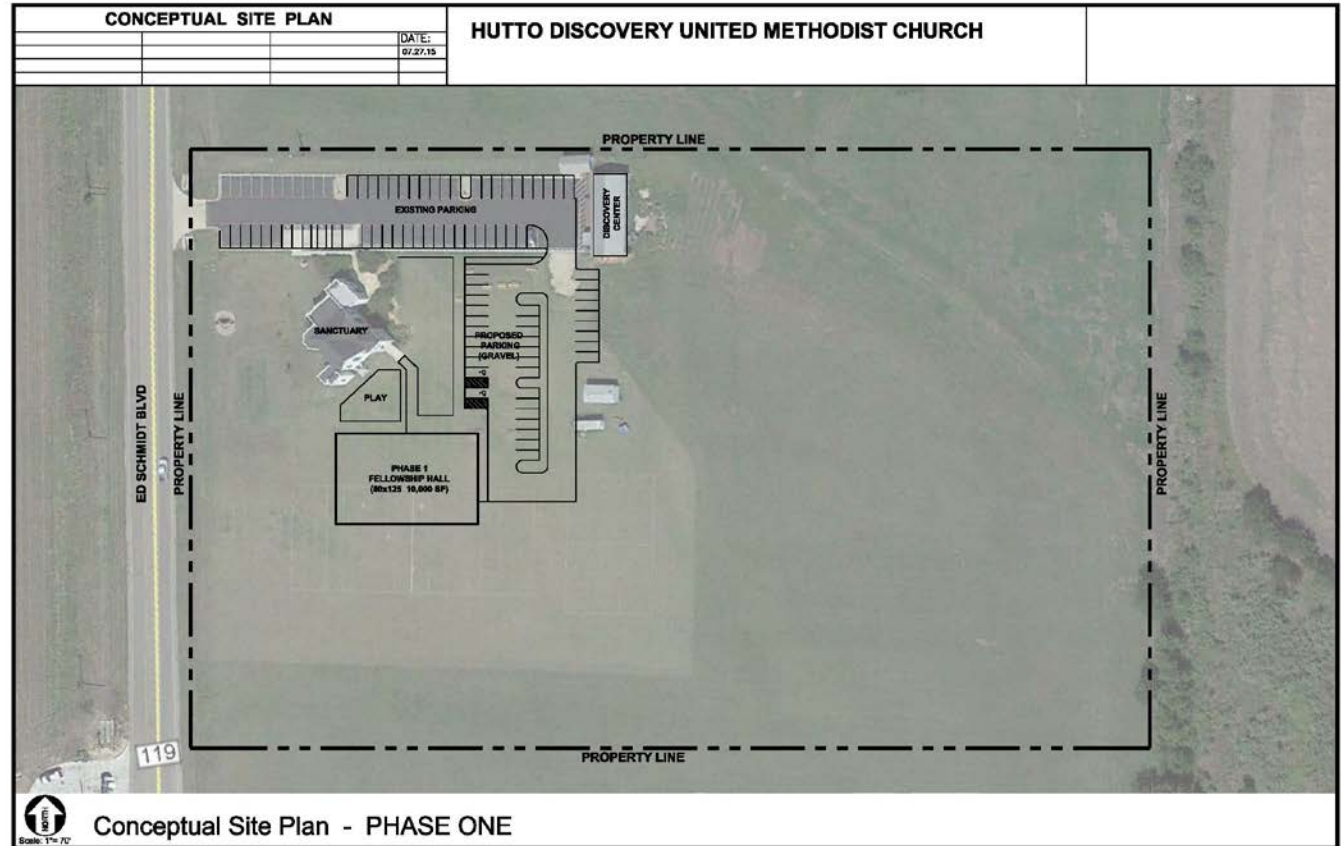

# Phase I - 2016

- ① New 10,000 SF Fellowship Hall
- ② New Playground
- ③ New Additional Parking Lot (gravel)
- ④ New Sidewalks and Pathways between existing Sanctuary, Fellowship Hall, Playground, and Parking Lots

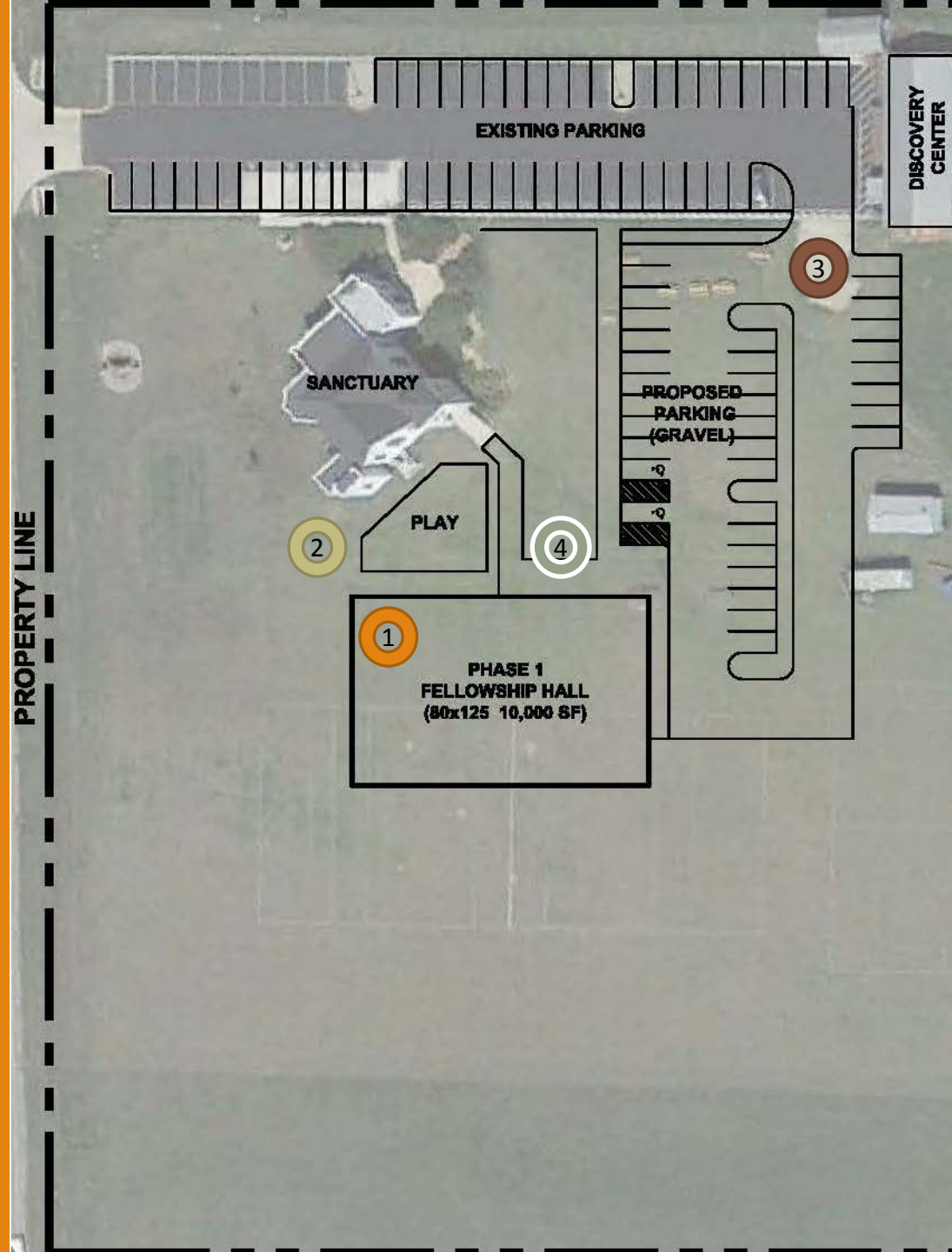

Fellowship Hall to potentially include:

Multi-Purpose Activity Area

Worship Area

Nursery

Serving Kitchen

Classrooms

# Phase II - 2021

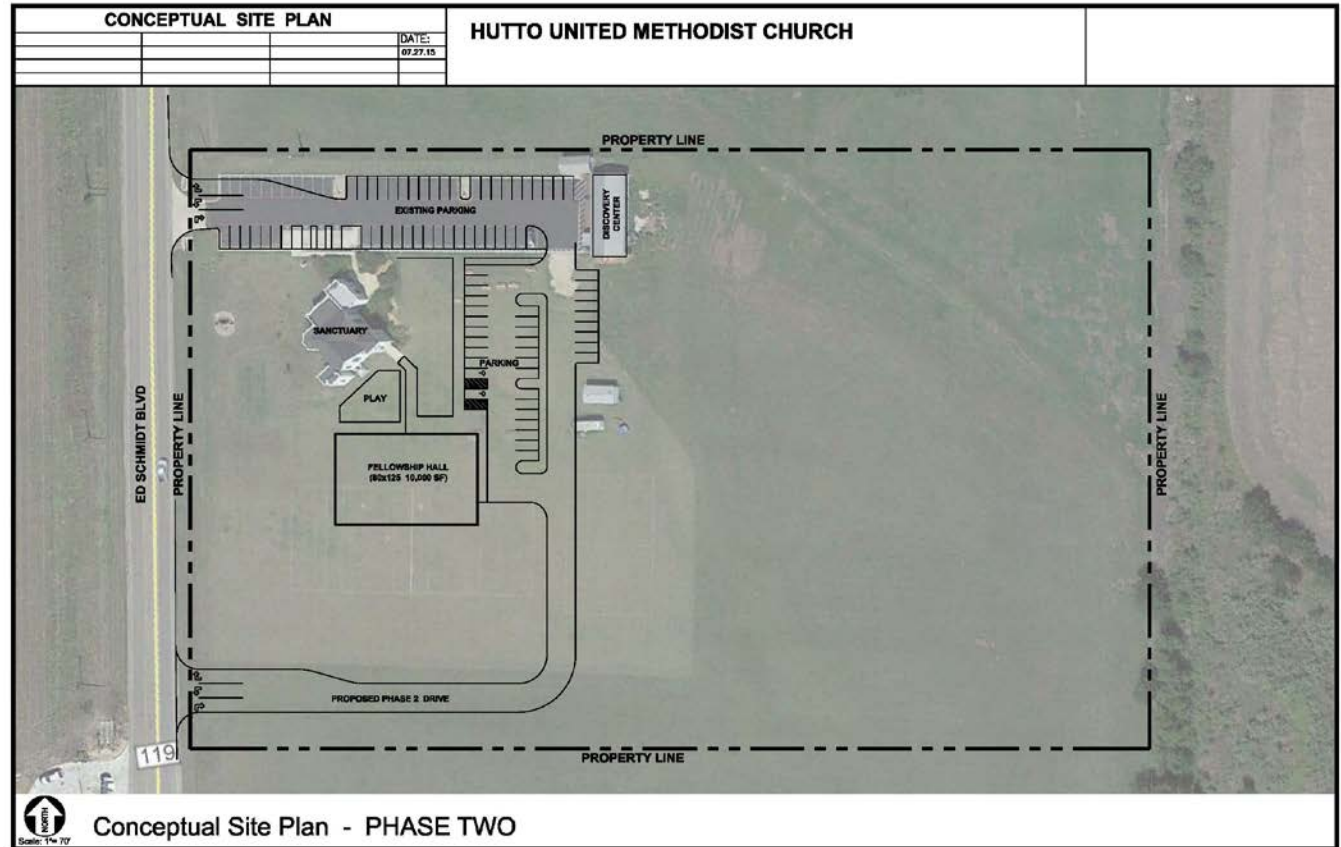

## Phase II - 2021

- ① New South Drive with 3 Lanes
- ② Expand North Drive to be 3 Lanes
- ③ Pave Phase I Parking Lot (previously gravel)
- ④ Reseal and Restripe Existing Parking Lot

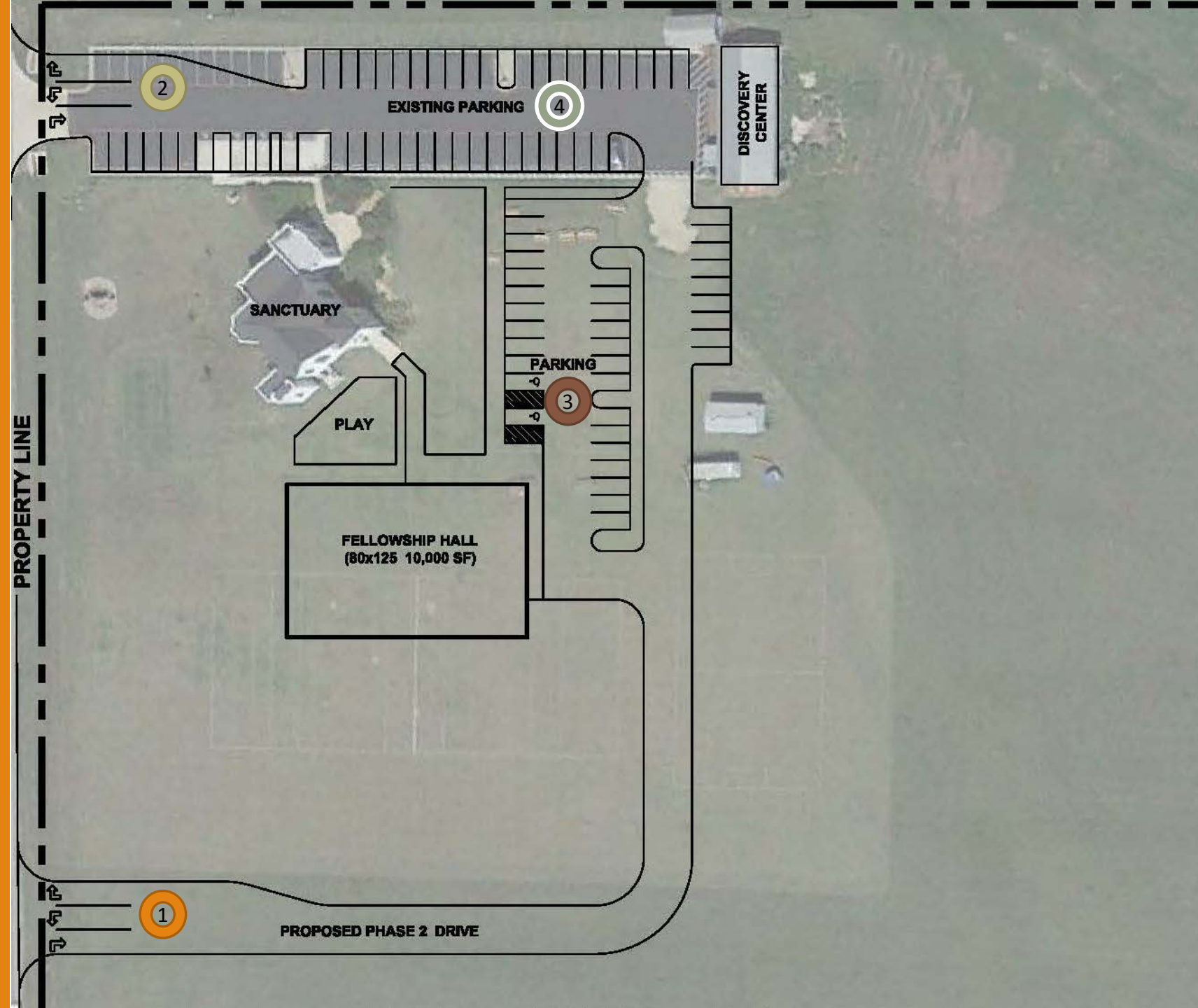

# Phase III - 2026

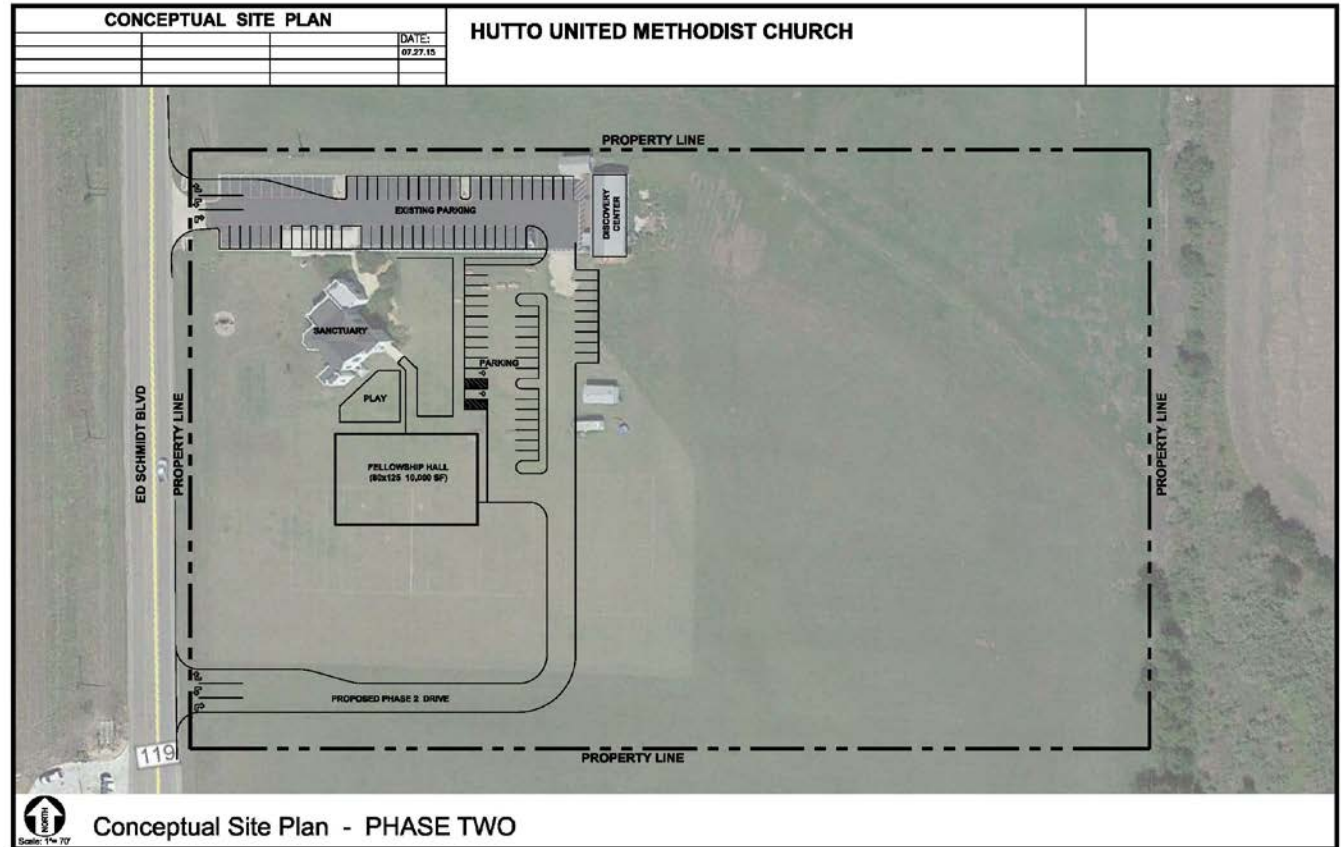



## Phase III - 2026

- ① Renovate Existing 100+ Year Old Sanctuary
- ② Update Signage
- ③ Install Irrigation
- ④ Update Landscaping & General Property Beautification



Phase IV - 2031

Phase V - 2036

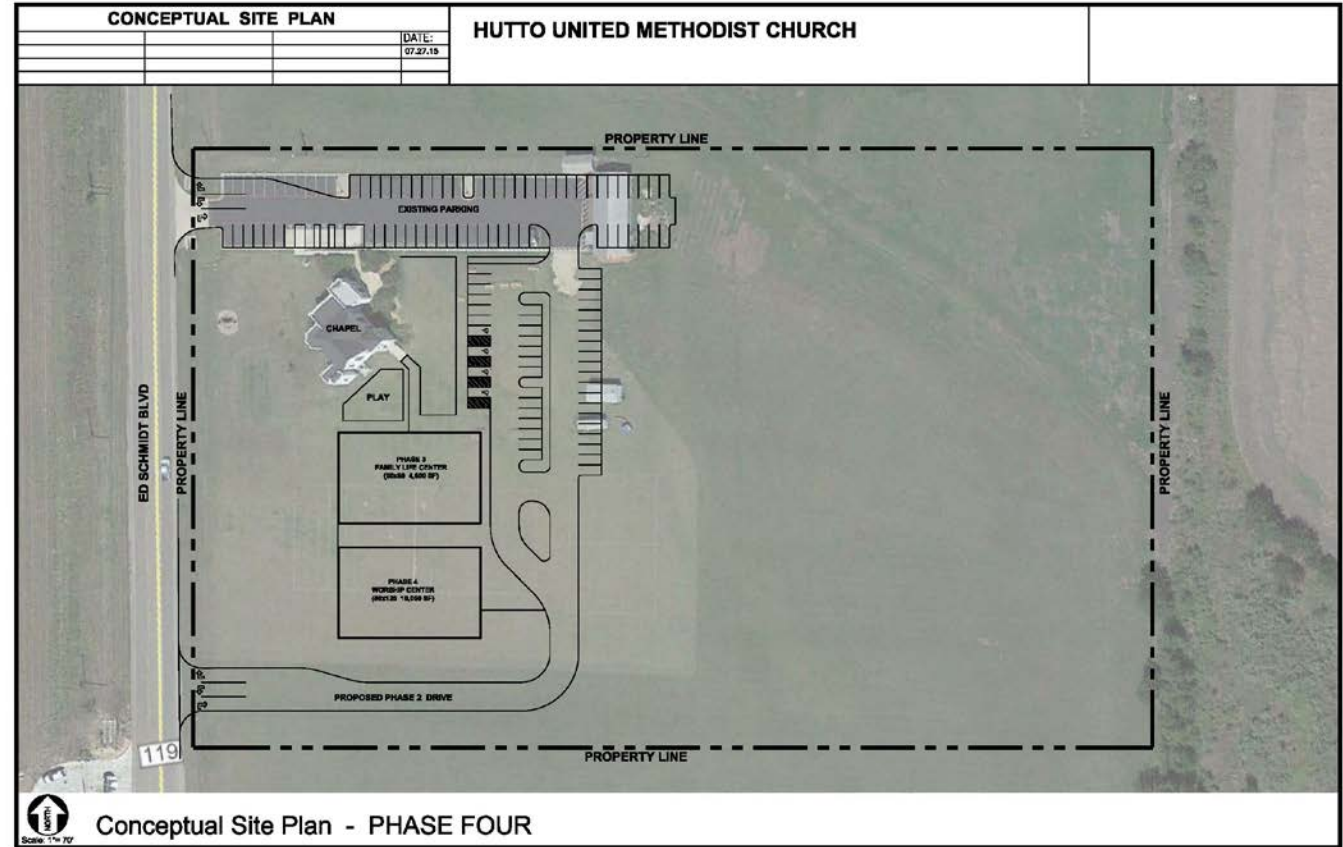

## Phase IV - 2031

- ① New 10,000 SF Worship Center
- ② Additional Parking and Access Drive
- ③ Repurpose Fellowship Hall (Phase I) to Family Life Center and Existing Sanctuary to a Chapel

## Phase V - 2036

- ④ Remove Discovery Center when needed for Additional Parking

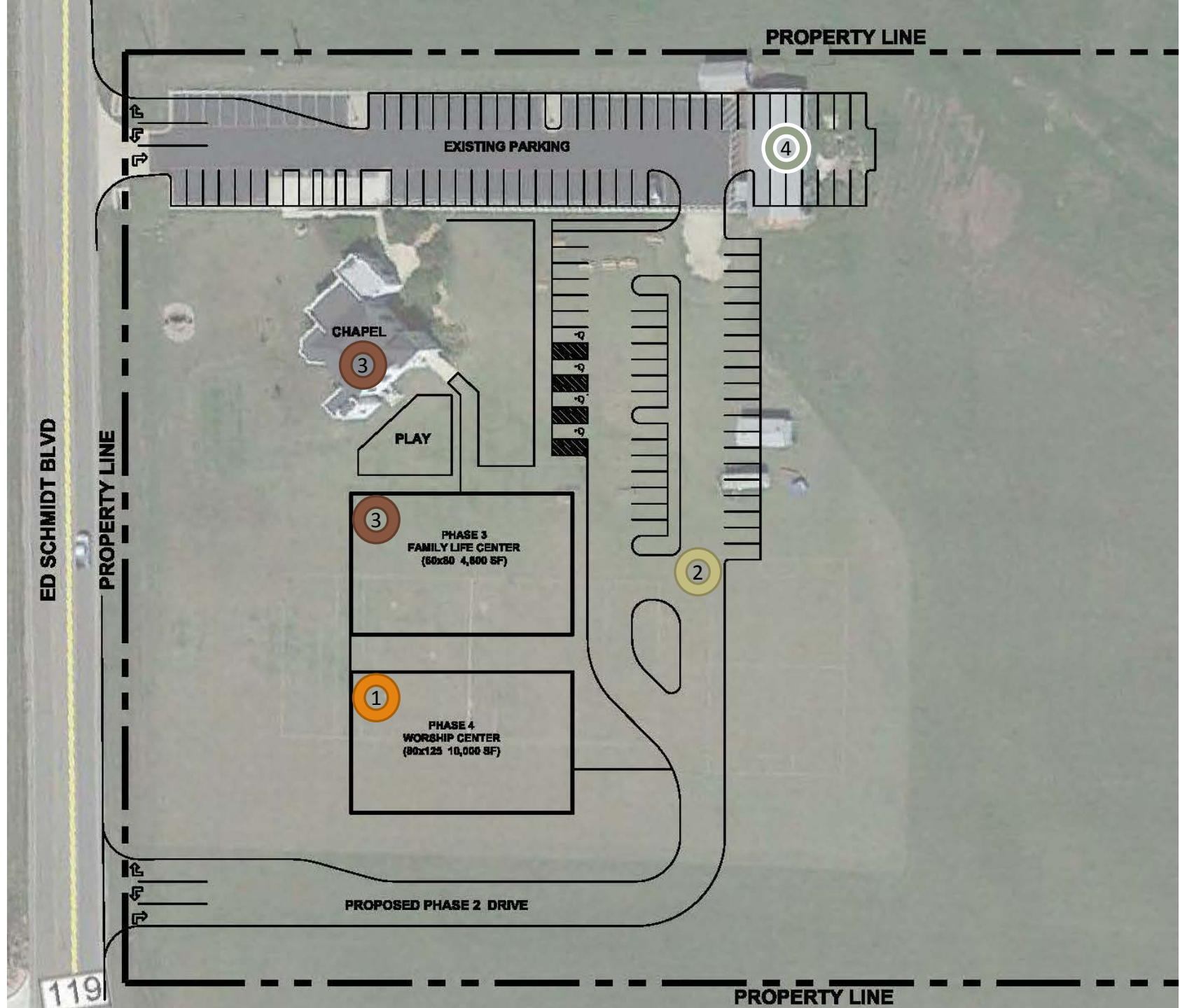

# Next Steps: Study Committee

---

As provided in the Book of Discipline, a Study Committee has been formed to collect information to see if the church needs a new building. Members will begin their work today to analyze the needs of the church and community, project potential membership, write up church's program of ministry, and develop an accessibility plan.

## **Study Committee Members include:**

Erin Leshikar

Janice Hester

Micah Grau

Michel Hudson

Patrick Kirkland

# Site Planning Team FAQs

---

If you have any questions, please call, text or email Stacy Henderson. A list of answers to Frequently Asked Questions will be provided within the week.

**Stacy Henderson**

**(512) 965-5325 call/text**

**[stacy@huttodiscovery.org](mailto:stacy@huttodiscovery.org)**

Available Next Sunday, August 16

---

Next Sunday, August 16, immediately following both services, members of the Site Planning Team will be available in The Gathering Room to show these slides again and to answer any questions.

# Questions or Feedback?

---

Please discuss with your **Site Planning Team** volunteers:

**Stacy Henderson**

[stacy@huttodiscovery.org](mailto:stacy@huttodiscovery.org)

(512) 965-5325

Leslie Heine

Phillip Graves

Deloris Beard

Yvette Pritchett

We want to  
hear from you!